

Design Edward Van Vliet - 2018



' vol. 1 **SOFAS AND SEATING SYSTEMS**

SOFAS and SEATING ELEMENTS for COMPOSITIONS

Structure is injected flame-retardant polyurethane foam and polyester fiberfill over internal steel and wood frame.
 Seat cushions are in goose down over polyurethane foam.
 Back, armrest and optional cushions are goose down.
 Feet are in tubular steel with powder coat finish or in varnished ash.

The Josh collection covers are removable.

Cover prices upon request.

' vol. 1 **DIVANI E SISTEMI DI SEDUTE**

DIVANI ed ELEMENTI DI SEDUTA per COMPOSIZIONI

Basi in poliuretano schiumato a freddo ignifugo e fibra poliestere con struttura interna in legno e acciaio.
 I cuscini di seduta sono in piuma d'oca con l'inserito in poliuretano espanso. I cuscini dello schienale, del bracciolo e quelli opzionali sono in piuma d'oca.
 Piedi in tubo di acciaio verniciato a polveri o in legno di frassino verniciato.

La collezione Josh è sfoderabile.

Prezzo fodera su richiesta.



Recommended fabric hangers

Tirelle e tessuti consigliati

- Ikebana A6760
- Birds A6761
- Leafs A6762
- 135-Spring Palette

Steel colors Colori acciaio



nickel colored steel

Wood colors Colori legno



ASH grey



ASH graphite



ASH shell



ASH pale tan



ASH tropical wood

Example for composition

B01

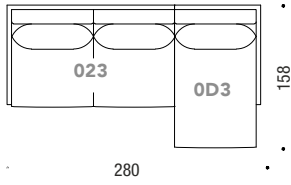

B00

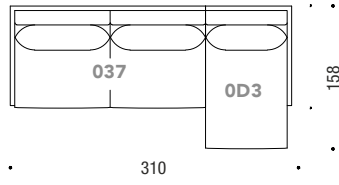

B20

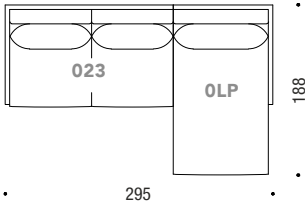

B50

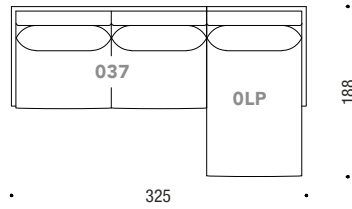

B10

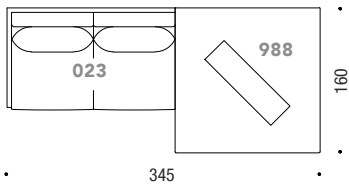

B40

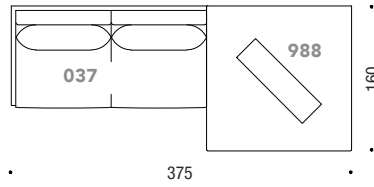

A12

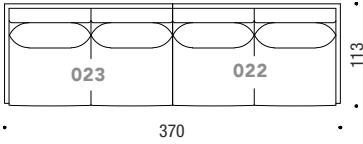

B80

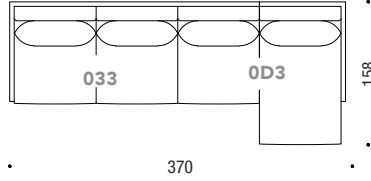

B30

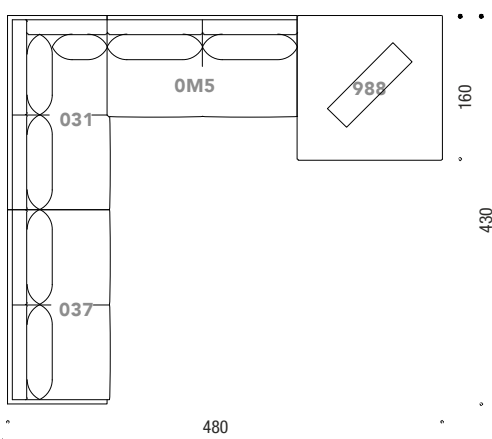

B60

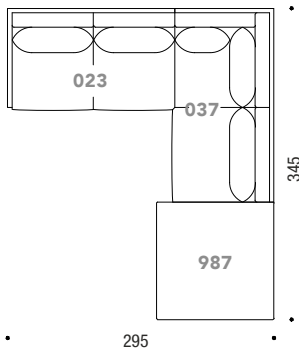

2 seater sofa

Divano 2 posti

002

8,8 mt. ★ 16,8 m² 1,9 m³ 90 Kg

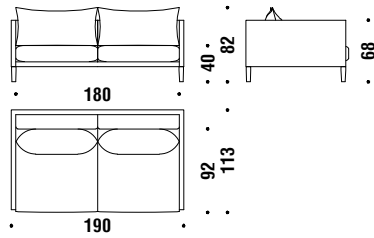

2 seater sofa major

Divano 2 posti major

018

9,4 mt. ★ 17,9 m² 2,1 m³ 95 Kg

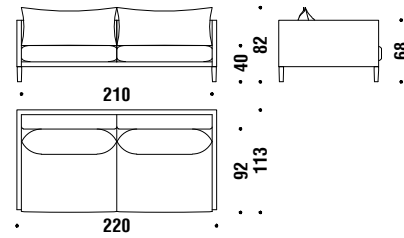

3 seater sofa

Divano 3 posti

003

9,9 mt. ★ 18,8 m² 2,6 m³ 110 Kg

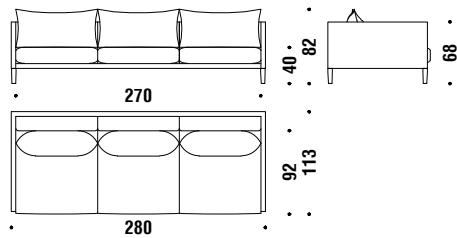

Element left 95

Elemento sinistro 95

N01

5,9 mt. ★ 11,1 m² 1 m³ 35 Kg

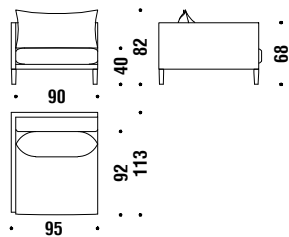

Element right 95

Elemento destro 95

N02

5,9 mt. ★ 11,1 m² 1 m³ 35 Kg

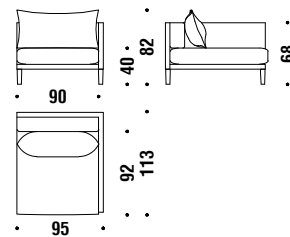

Central element 90

Elemento centrale 90

N03

4,4 mt. ★ 8,4 m² 1 m³ 35 Kg

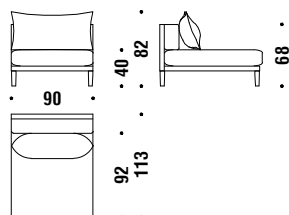

Element left 110

Elemento sinistro 110

N04

6,1 mt. ★ 11,6 m² 0,7 m³ 40 Kg

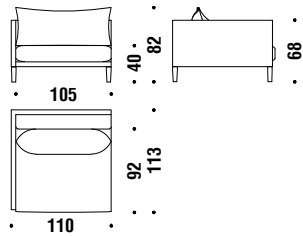

Element right 110

Elemento destro 110

N05

6,1 mt. ★ 11,6 m² 0,7 m³ 40 Kg

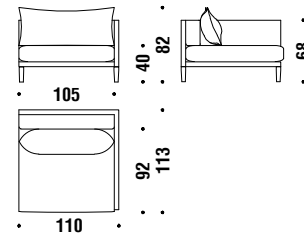

2 seater central element

Elem.2p centrale

07A

6,4 mt. ★ 12,1 m² 1,9 m³ 65 Kg

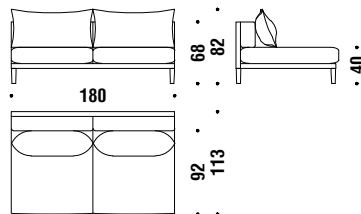

Lateral 2 seat unit left

Elemento 2 posti sinistro

023

7,6 mt. ★ 14,4 m² 1,9 m³ 80 Kg

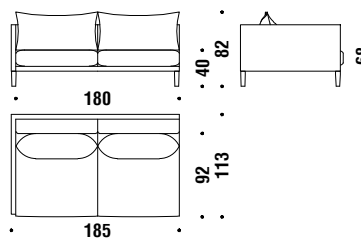

Lateral 2 seat unit right

Elemento 2 posti destro

022

7,6 mt. ★ 14,4 m² 1,9 m³ 80 Kg

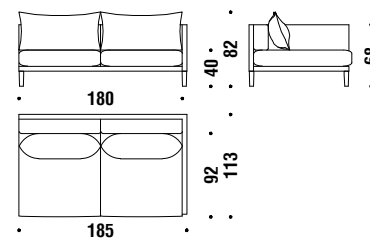

Lateral 2 seat left peninsula

Penisola 2p sinistra

0TH

6,4 mt. ★ 12,1 m² 1,9 m³ 80 Kg

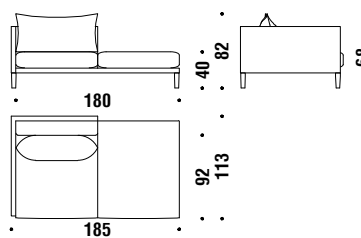

Lateral 2 seat right peninsula

Penisola 2p destra

0TG

6,4 mt. ★ 12,1 m² 1,9 m³ 80 Kg

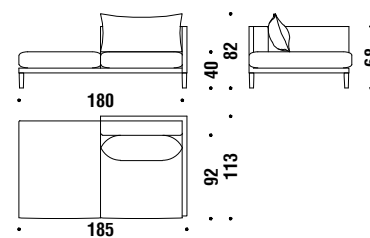

2 seater major central element

Elem.2p centrale major

0M5

7,1 mt. ★ 13,5 m² 2,1 m³ 80 Kg

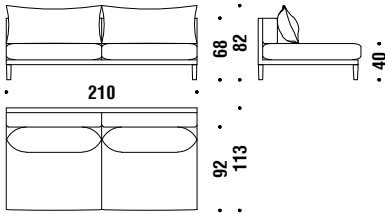

Lateral 2 seat unit major left

Elem.2p major sx

037

8,3 mt. ★ 15,8 m² 2,1 m³ 83 Kg

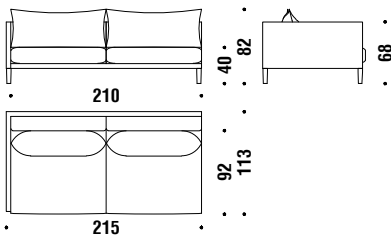

Lateral 2 seat unit major right

Elem.2p major dx

031

8,3 mt. ★ 15,8 m² 2,1 m³ 83 Kg

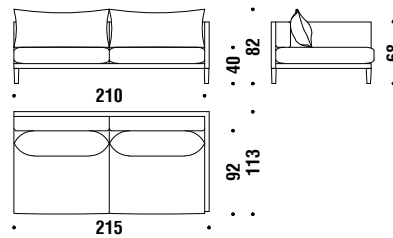

Lateral 3 seat unit left

Elemento 3p sinistro

033

8,7 mt. ★ 16,5 m² 2,6 m³ 95 Kg

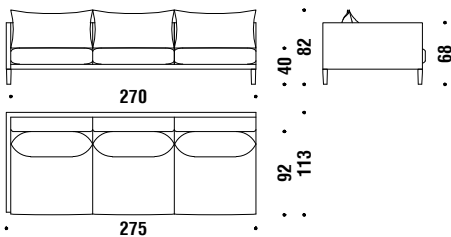

Lateral 3 seat unit right

Elemento 3p destro

032

8,7 mt. ★ 16,5 m² 2,6 m³ 95 Kg

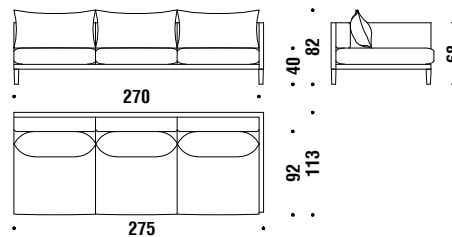

Lateral 2 seat major left peninsula

Penisola 2p mj sx

OTM

7,1 mt. ★ 13,4 m² 2,1 m³ 70 Kg

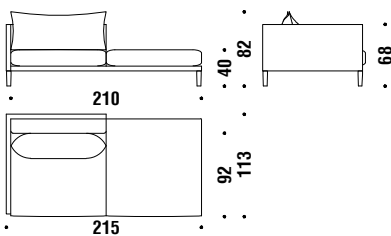

Lateral 2 seat major right peninsula

Penisola 2p mj dx

OTL

7,1 mt. ★ 13,4 m² 2,1 m³ 70 Kg

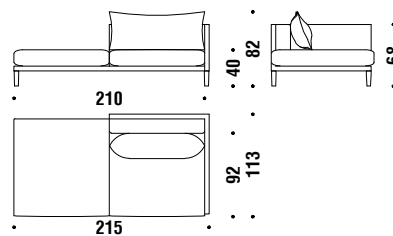

Chaise Longue left 95x160

Chaise Longue sinistra 95x160

OD4

7,2 mt. ★ 13,7 m² 1,4 m³ 65 Kg

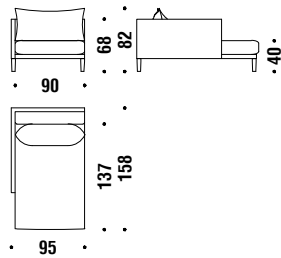

Chaise Longue right 95x160

Chaise Longue destra 95x160

OD3

7,2 mt. ★ 13,7 m² 1,4 m³ 65 Kg

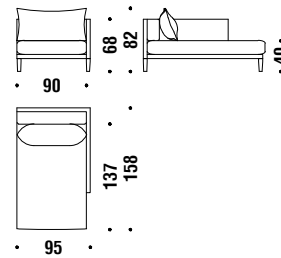

Chaise Longue left 110x190

Chaise Longue sinistra 110x190

OLQ

7,6 mt. ★ 14,4 m² 1,9 m³ 85 Kg

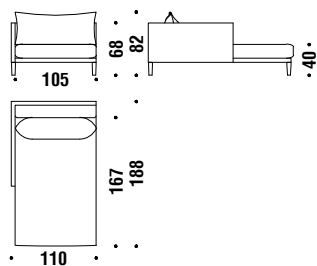

Chaise Longue right 110x190

Chaise Longue destra 110x190

OLP

7,6 mt. ★ 14,4 m² 1,9 m³ 85 Kg

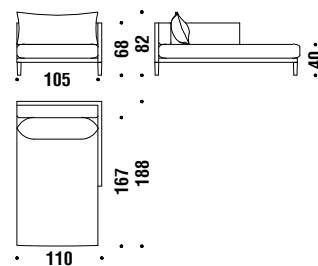

Stool 107x107

Pouf 107x107

775

8,3 mt. ★ 15,8 m² 0,7 m³ 35 Kg

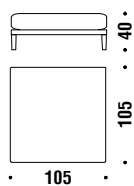

Bench 130x130

Panca 130x130

987

8,8 mt. ★ 16,8 m² 0,9 m³ 55 Kg

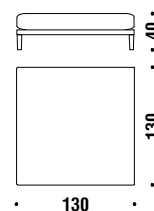

Bench 160x160

Panca 160x160

988

9,4 mt. ★ 17,8 m² 1,5 m³ 75 Kg

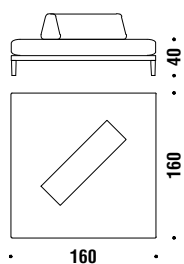

Composition A12

Composizione A12

A12

15,2 mt. ★ 28,8 m² 3,8 m³ 160 Kg

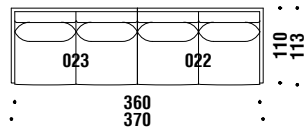

Composition B1 right or B1 left

Composizione B1Dx-B1Sx

B01

14,8 mt. ★ 28,1 m² 3,3 m³ 145 Kg

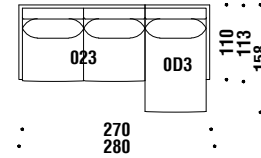

Composition B20R or B20L

Composizione B20Dx-B20Sx

B20

15,2 mt. ★ 28,8 m² 3,8 m³ 165 Kg

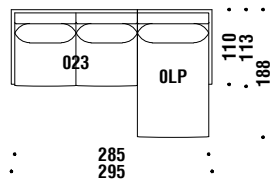

Composition B right or B left

Composizione BDx-BSx

B00

15,5 mt. ★ 29,5 m² 3,5 m³ 148 Kg

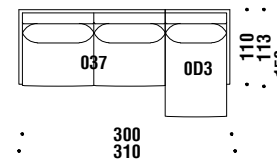

Composition B80R or B80L

Composizione B80Dx-B80Sx

B80

15,9 mt. ★ 30,2 m² 4 m³ 160 Kg

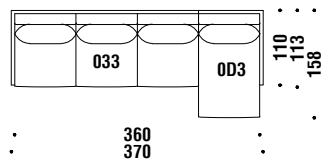

Composition B50R or B50L

Composizione B50Dx-B50Sx

B50

15,9 mt. ★ 30,2 m² 4 m³ 168 Kg

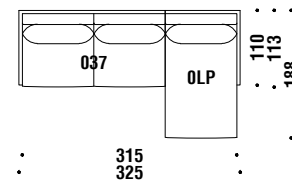

Composition B10R or B10L

Composizione B10Dx-B10Sx

B10

17 mt. ★ 32,2 m² 3,4 m³ 155 Kg

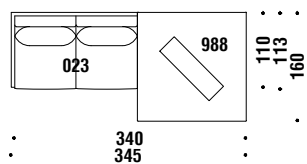

Composition B40R or B40L

Composizione B40Dx-B40Sx

B40

17,7 mt. ★ 33,6 m² 3,6 m³ 158 Kg

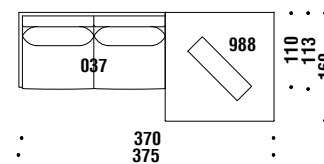

Composition B60R or B60L

Composizione B60Dx-B60Sx

B60

24,7 mt. 47 m² 4,9 m³ 218 Kg

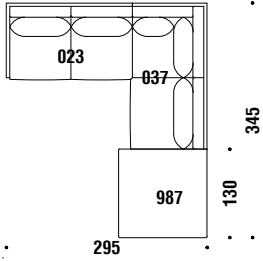

Composition B30R or B30L

Composizione B30Dx-B30Sx

B30

33,1 mt. 62,9 m² 7,8 m³ 321 Kg

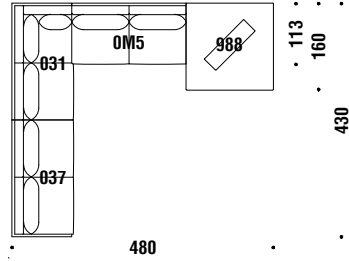

Composition B70R or B70L

Composizione B70Dx-B70Sx

B70

33,2 mt. 63,2 m² 7 m³ 284 Kg

